

# D1-50/180-2MV-R

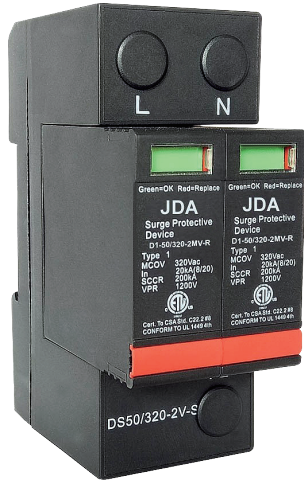

Basic circuit diagram

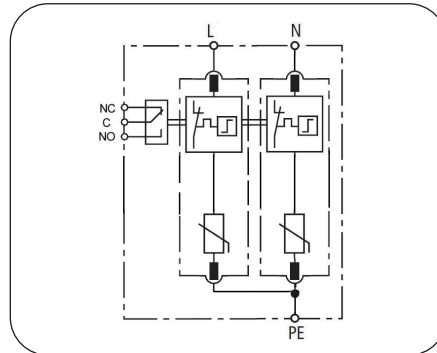

Dimension drawing

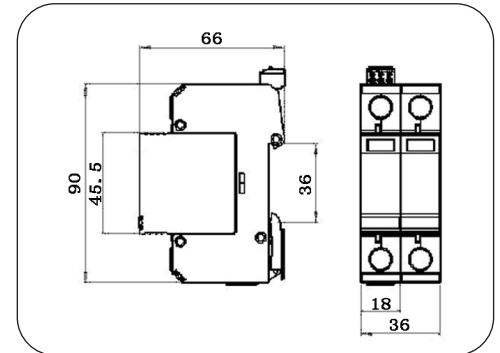

Type 1 surge protective device especially designed for low-voltage power supply system at the boundaries from lightning protection zone 1-2 and higher.

- ◎ Type 1CA surge suppressor, passed intermediate current 100A, 500A, 1000A and short circuit current rating (SCCR) 200kA without external fuse or circuit breaker.
- ◎ ETL certified surge protector according to UL1449-4th
- ◎ Pluggable design with window fault indication
- ◎ Nominal discharge current In 20kA 8/20 per pole, max discharge current I<sub>max</sub> 50kA 8/20 per pole
- ◎ High reliability due to global patented thermally protected MOV (TMOV) with special arc-extinguish device

Part No.	D1-50/180-2MV-R
In accordance with	UL1449-4th
Category IEC/VDE	Type1CA
Max. continuous operating voltage MCOV (VAC/VDC)	180/240
Nominal discharge current(8/20) I <sub>n</sub>	20kA
Max. discharge current(8/20) I <sub>max</sub>	50kA
Voltage protection rating @ VPR	<0.7kV
Response time	≤ 25ns
Follow current	No
Backup fuse(only required if not already provided in mains)	125A gL/gG
Operating temperature range	- 40°C ~ + 80°C
Cross-section of connection wire	Single-strand 35mm <sup>2</sup> ; multi-strand 25mm <sup>2</sup>
Mounting	35mm DIN-rail in accordance with EN 50022/DIN46277-3
Enclosure material	thermoplastic; extinguishing degree UL94 V-0
Degree of protection	IP20
Installation width	2 modules, DIN 43880
Thermal disconnecter	Internal green – normal ; red - failure
Remote alarm contact	Yes
SCCR rating	200kA
Approvals, Certifications	ETL/CE
Remote alarm contact type	Isolated Form C
Switching capability Un/In	AC: 250V/0.5A DC: 250V/0.1A; 125V/0.2A; 75V/0.5A
Max. Size of connecting wire	Max. 1.5mm <sup>2</sup> (or # 16AWG)

Note: Subject to change without any notice.