



SOLAR PV FUSE HOLDER FOR CYLINDRICAL FUSE-LINKS SIZE 10x38, DC DESIGN

- Fuse disconnectors FH are intended for cylindrical fuse-links size 10x38.
- Fuse disconnectors FH can be sealed in the closed state.
- The devices are designed as modular for 45 mm cutout in the switchboard.

Part No	I_n [A]	Rate Voltage	Number of poles	Package[pcs]
FH-01	32	1000Vdc	1	12
FH-01-L	32	1000Vdc	1	12



Parameters		
Rated operating current	I_e	32 A
Rated operating voltage	U_e	1000 V d.c.
Utilization category		DC-20B
Rated insulation voltage	U_i	1000 V d.c. ⁽¹⁾
Rated pulse withstand voltage	U_{imp}	4KV
Fuse-link	Diameter x length	10x38
Max. rated current of the fuse-link		30A
Max. power losses of the fuse-link		3W
Rated short-time withstand current	I_{cw} 1s	1.6KA
Electrical endurance (operating cycles)		300
Mechanical endurance (operating cycles)		1700
Degree of protection, cover closed		IP20
Degree of protection, cover opened		IP20
Connection cross-section		Cu/0.5÷25mm ² (2x16mm ²)
Torque		2 Nm
Operating ambient temperature	t	-25÷+55℃
Max. sea level		2000m
Material body and handle		thermoplastic high resistance to the temperature,PBT
Flammability		UL 94 - V0
Glow Wire Test		IEC 60695 , 960 °C
Colour		Ral 7035
Material of contacts		electrolytic silver plated copper or Phosphor bronze.
Standards		IEC 60947-1,-3 ; EN 60947-1,-3

Note: (1) also suitable for 695Vac. application

Dimensions

FH01 /Din rail mounting

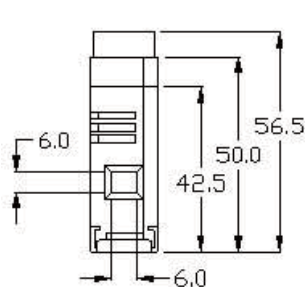
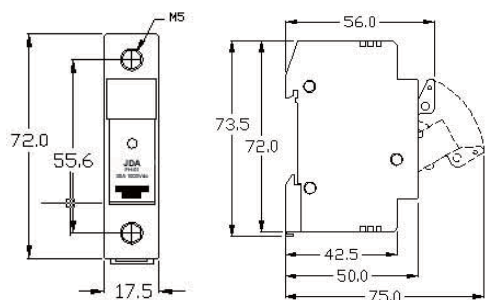

Diagram

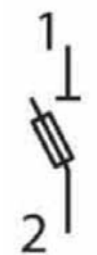

1-pole

Note: Subject to change without any notice.